

SIGN	DESCRIPTION	DATE	APPROVER

Technical Data:

Material:

Terminals: Copper Alloy, Tin Plated
Terminal screw: Steel galvanized with Cr3+ plated
Cover: PC (UL94V-0)

Insulator body (housing): Polyamide (Glass filled) (UL94V-0)

Electrical

Voltage rating: 300VAC
Current rating: 20 Amps/way max
Contact resistance: 20m Ω (max)
Withstanding Voltage: 2500VAC(1min) Test time=60sec/1pcs
Wire range: 14-22AWG

Mechanical:

Torque: 12kgf.cm/M3.5 Operating temperature: -40°C to +105°C
Soldering reliability:
Test temperature= 250°C ± 10°C
5 seconds max

Ordering Information:

U250 - 1 - 9 XX - X X X 0

- A Black Pa66
- B Black Pbt
- 1 With flange
- 2 Without flange
- 1 "-" Screw Cr³⁺
- 2 "-/+" Screw Cr³⁺
- 3 "-" Screw Ni Plated
- 4 "-/+" Screw Ni Plated
- 02 2Pin
- To To
- 32 32Pin

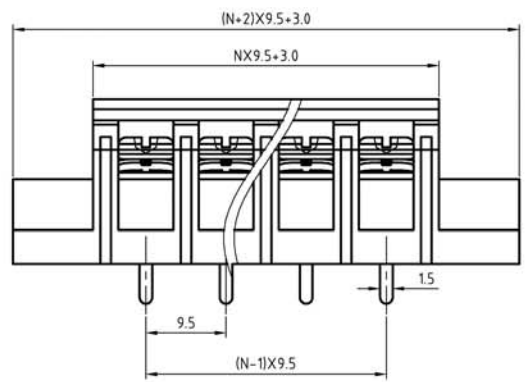
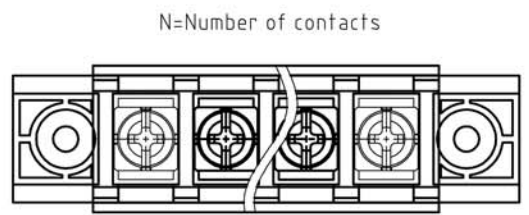

P.C.B LAYOUT

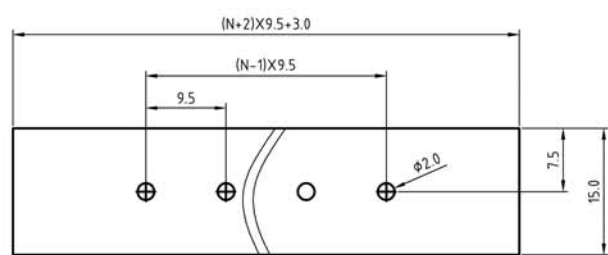
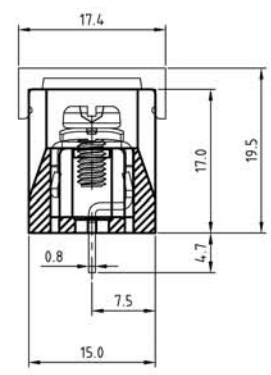

WELINK 上海拓尔普电子科技有限公司
Welink International Co., LTD.

TOLERANCE	APPROVED:	NAME: U250-1 Pitch 9.5mm
X. ±0.50	CHECKED:	series With flange
X.X ±0.30	DRAWN: Yang Ming 2013,10,21	PART NO: U25019XX21B0
X.XX ±0.20	UNITS: mm REV: A	DWG NO: 9U2501101A
X° ±1°	SCALE: 1.5/ 1 PAGE: 1 / 1	