

SIGN	DESCRIPTION	DATE	APPROVER

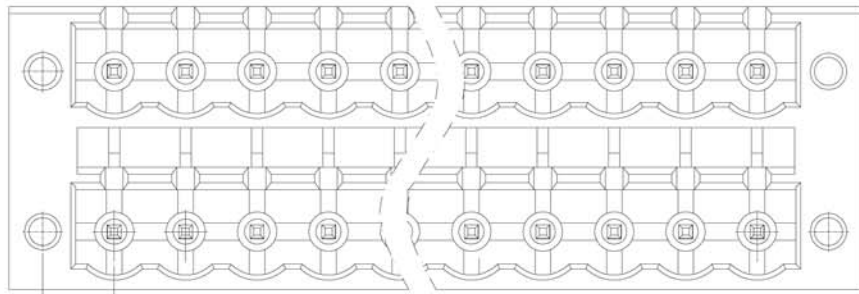

5.08

N=Number of contacts

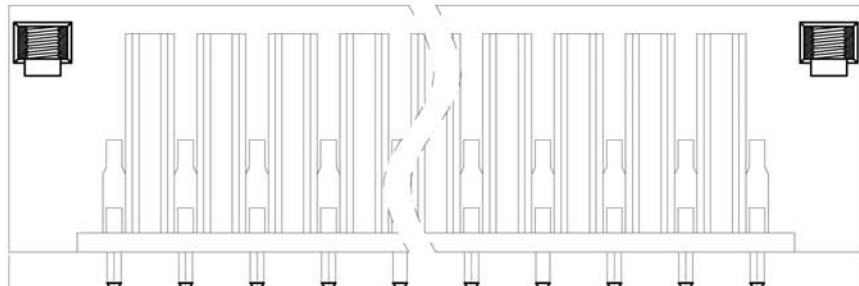

7.5

5.08

(N-1) x 5.08

(N-1) x 5.08 + 15.0

1.0

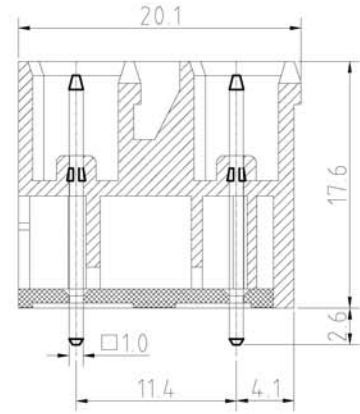

20.1

17.6

2.6

11.4

4.1

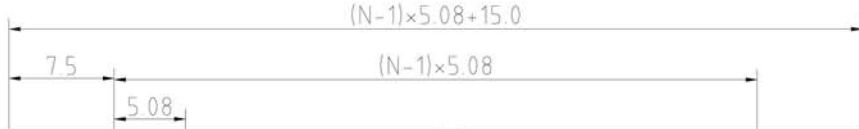

7.5

5.08

(N-1) x 5.08 + 15.0

(N-1) x 5.08

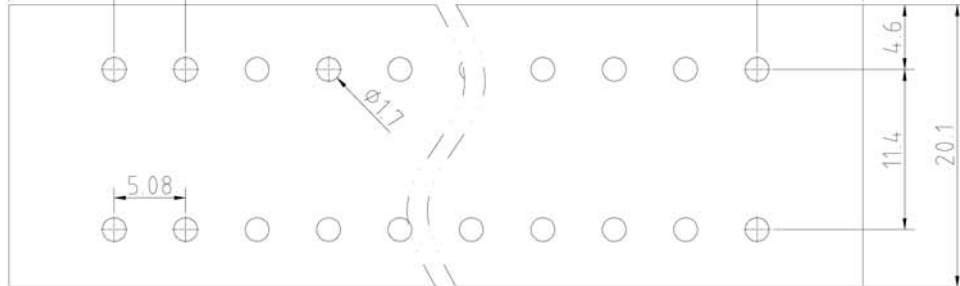

5.08

φ1.7

4.6

11.4

20.1

P.C.B. LAYOUT

Technical Data:

Material:

Solder Pin: Copper Alloy with Tin plated
 Insulator body(housing): Polyamide
 (Glass filled)(UL94V-0)

Electrical

Voltage rating: 300VAC
 Current rating: 16A
 Withstanding Voltage: AC 2500V(1min)

Mechanical:

Using temperature Range: -40°C to +105°C
 Soldering temperature: +250°C, 5seconds Max.

Ordering Information:

F85-R-E XX-0 0 0 X 0 0 0 0

- | | | | |
|----|-------|---|----------------|
| 02 | 2Pin | 5 | Green |
| To | To | 6 | Blue |
| 24 | 24Pin | A | Black |
| | | 0 | Open |
| | | 1 | Close |
| | | 2 | Screw nut |
| | | 3 | Square nut |
| | | 4 | W/Latch holder |
| 0 | 180° | | |
| 1 | 90° | | |

WELINK

上海拓尔普电子科技有限公司
 Welink International Co.,LTD.

TOLERANCE X. ±0.50 X.X ±0.30 X.XX ±0.20 X° ±*	APPROVED:	NAME: F85-R Pitch 5.08mm -Series -180°(Square nut)
	CHECKED:	
	DRAWN: Ling Yu 2014,09,18	
	UNITS: mm	REV: A
	SCALE: 2.5 / 1	PAGE: 1 / 1
		PART NO: F85REXX003X0000
		DWG NO: 9F85RE031A